

Tried and True Native Plants

Best Bets for Dry Conditions

Best Bets: Plants
for Particular Uses
in the Mid-Atlantic

These plants adapt to drier, well-drained sites and can tolerate local rain shortages. Most thrive in sun and heat, although a few prefer locations with some shade. Some also grow well in exposed areas or on slopes.



Grasses, Sedges & Rushes

- Pennsylvania Sedge ([Carex pensylvanica](#))
- Pink Muhly ([Muhlenbergia capillaris](#))
- Little Bluestem ([Schizachyrium scoparium](#))
- Indian Grass ([Sorghastrum nutans](#))

Ground Covers

- Green-and-Gold ([Chrysogonum virginianum](#))
- White Wood Aster ([Eurybia divaricata](#))
- Eastern Prickly-pear ([Opuntia humifusa](#))
- Fragrant Sumac ([Rhus aromatica ‘Gro-Low’](#))

Perennials

- Butterfly-weed ([Asclepias tuberosa](#))
- Blue Wild Indigo ([Baptisia australis](#))
- Threadleaf Coreopsis ([Coreopsis verticillata](#))
- Purple Coneflower ([Echinacea purpurea](#))
- Hyssop-leaf Thoroughwort ([Eupatorium hyssopifolium](#))
- Black-eyed Susan ([Rudbeckia hirta](#))

Shrubs

- Mountain Laurel ([Kalmia latifolia](#))
- Eastern Ninebark ([Physocarpus opulifolius](#))
- Black Haw ([Viburnum prunifolium](#))
- Common Yucca ([Yucca filamentosa](#))

Trees

- Downy Serviceberry ([Amelanchier arborea](#))
- Cockspur Hawthorn ([Crataegus crus-galli](#))
- Eastern Redcedar ([Juniperus virginiana](#))
- Eastern Hophornbeam ([Ostrya virginiana](#))
- White Oak ([Quercus alba](#))
- Sassafras ([Sassafras albidum](#))

May, June, September & October Landscapes*

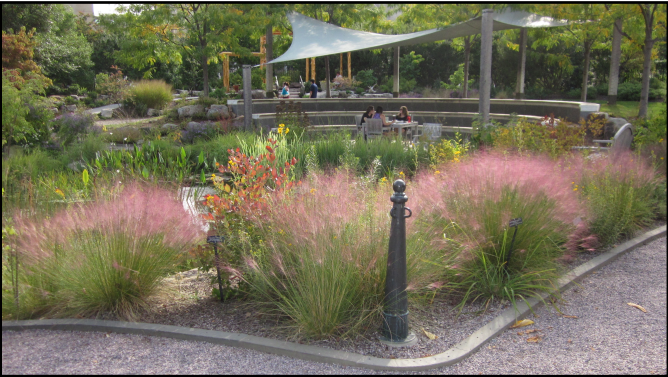

Learn More about These Plants

For detailed, individual plant fact sheets, use the Latin name hyperlinks in this table or visit [Tried & True Native Plants: Mid-Atlantic](#) on [mgnv.org](#).

*Fragrant sumac on a sloped, parking lot, planting strip. Verbena, yucca, butterfly-weed, coreopsis, and *Penstemon digitalis* in Bluemont Park’s Monarch Waystation. Pink muhly at the U.S. Botanic Garden. Prickly pears, lavender, grasses, and salvias in Simpson’s Waterwise Garden.

developed by Master Gardeners of Northern Virginia, serving Arlington and Alexandria

Images by Elaine Mills (fragrant sumac and pink muhly) and by Mary Free (monarch waystation and waterwise garden)



Virginia Cooperative Extension programs and employment are open to all, regardless of age, color, disability, gender, gender identity, gender expression, national origin, political affiliation, race, religion, sexual orientation, genetic information, veteran status, or any other basis protected by law. An equal opportunity/affirmative action employer. Issued in furtherance of Cooperative Extension work, Virginia Polytechnic Institute and State University, Virginia State University, and the U.S. Department of Agriculture cooperating. Edwin J. Jones, Director, Virginia Cooperative Extension, Virginia Tech, Blacksburg; M. Ray McKinnie, Administrator, 1890 Extension Program, Virginia State, Petersburg.